



Virtual Services Platform 9012 Module Installation

Start Here

Use this information to install Control Processor (CP), Switch Fabric (SF), and I/O modules in the chassis. The process to install the three types of modules is the same but the location is different. Install the CP and I/O modules horizontally in the front of the chassis; install the SF modules vertically in the back of the chassis. For the latest information about a specific release, see Avaya Virtual Services Platform 9000 Release Notes, NN46250-401.

Prerequisites

Gather the following tools:

- Phillips # 2 screwdriver
- Antistatic wrist strap

Protecting modules

⚠ CAUTION: Risk of equipment damage

Do not touch components or connector pins with your hand, or damage can result.

⚙ **Note:** If you have the optional external Flash card media for your CPU module, you must install it prior to power on of the Chassis and CPU modules.

You must have a minimum of 3 Switch Fabric modules installed for proper operation of the VSP 9000.

⚠ **Modules are heavy.** Damage to a module can occur if it's bumped into another object, including other modules installed in a chassis. Use both hands to support modules.

Always place the modules on appropriate antistatic material.

Support the module from underneath with two hands. Do not touch the top of the module. Do not touch the pins or electrical connections.

Do not leave slots open. Fill all slots with modules or filler modules to maintain safety compliance, proper cooling, and EMI containment.

Do not over tighten screws. Tighten until snug. Do not use a power tool to tighten screws.

Be careful not to bump a module's connectors against an adjacent module's ejector levers. Damage to connectors may result.

1 Unpacking a module

1. Remove the module from the box.
2. Slide your hand in to the anti-static bag and under the tray to support the whole module with one hand while you remove the bag with the other hand.
3. Hold the module from the underside of the tray with both hands. Do not hold the module by the faceplate. Avoid touching or grasping the top of the module. Component damage can result.

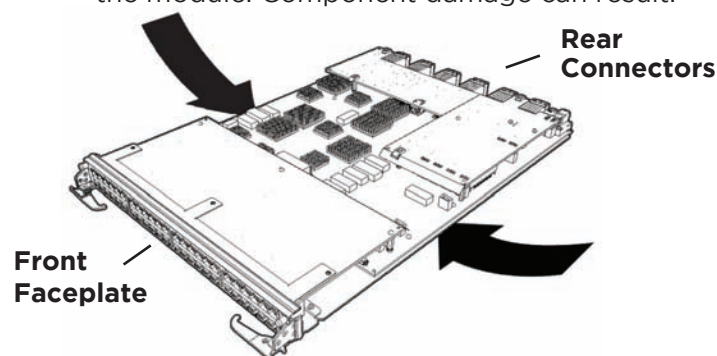

2 Installing a module

Locate the slot where you want to install the module. I/O modules should be installed starting at the bottom, with the highest slot number. When installing the Switch Fabric modules, for proper operation you must first populate slots SF4 and SF1 and then populate the rest of the slots. Slot numbering is illustrated below.

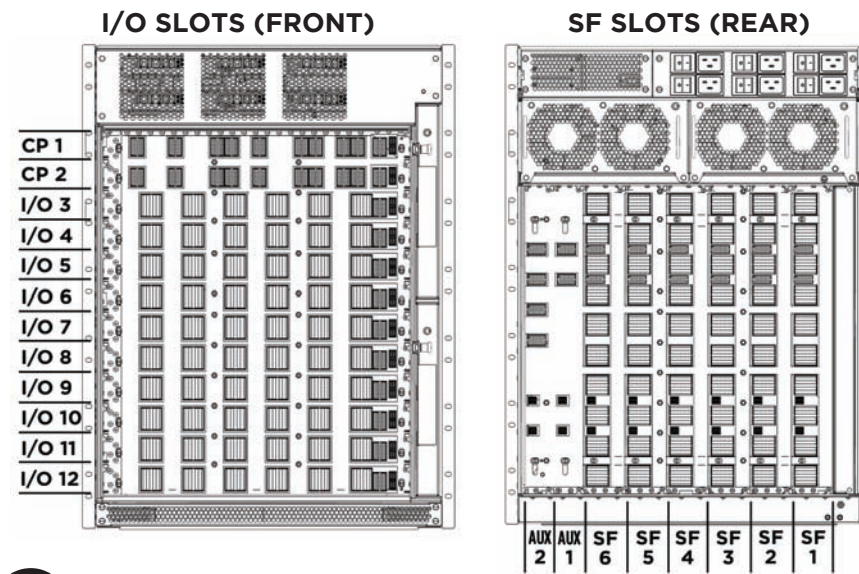

- 4 Before you fully insert the module into the slot, rotate the action levers away from the module until they form a 90° angle with the front of the module, then carefully slide the module partway into the slot.

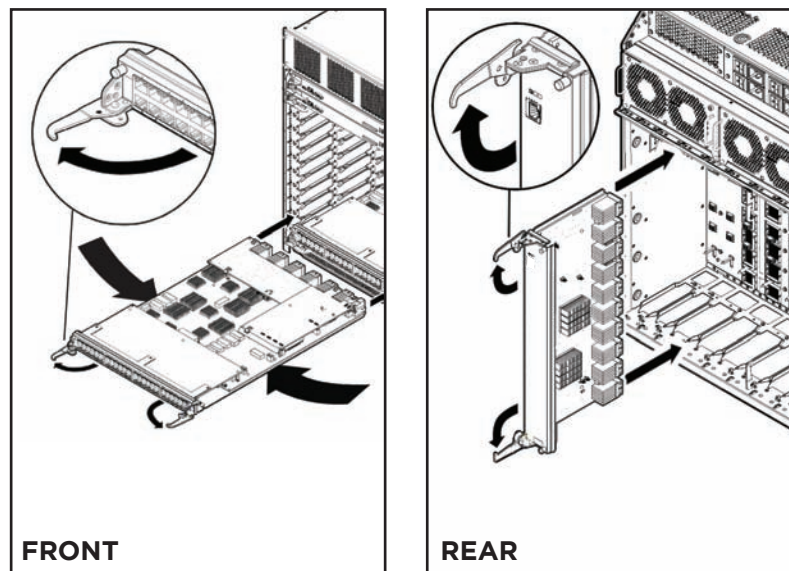

- 6 Continue seating the module by rotating the action levers until the levers are parallel with the front face panel and the module is fully seated.

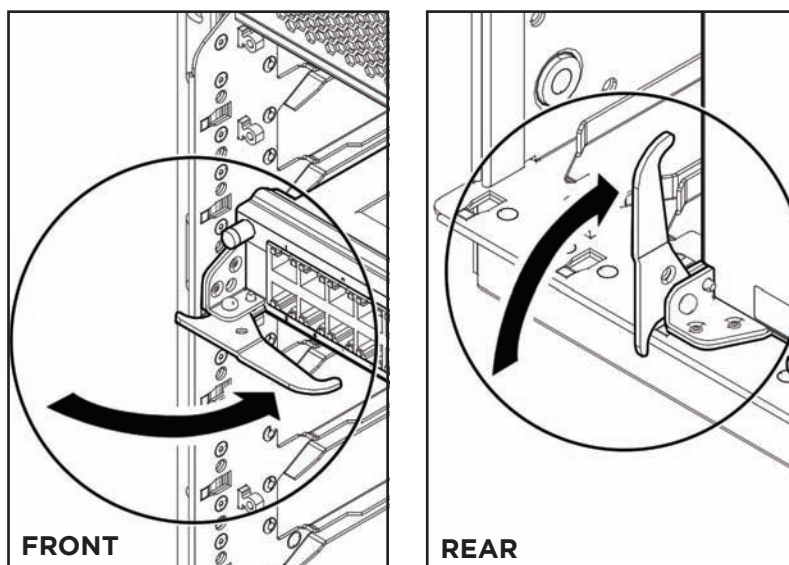

- 3 Align the module base-plate with the guide rails on either side of the opening for horizontal modules or the guide rails at the top and bottom of the opening for vertical modules.

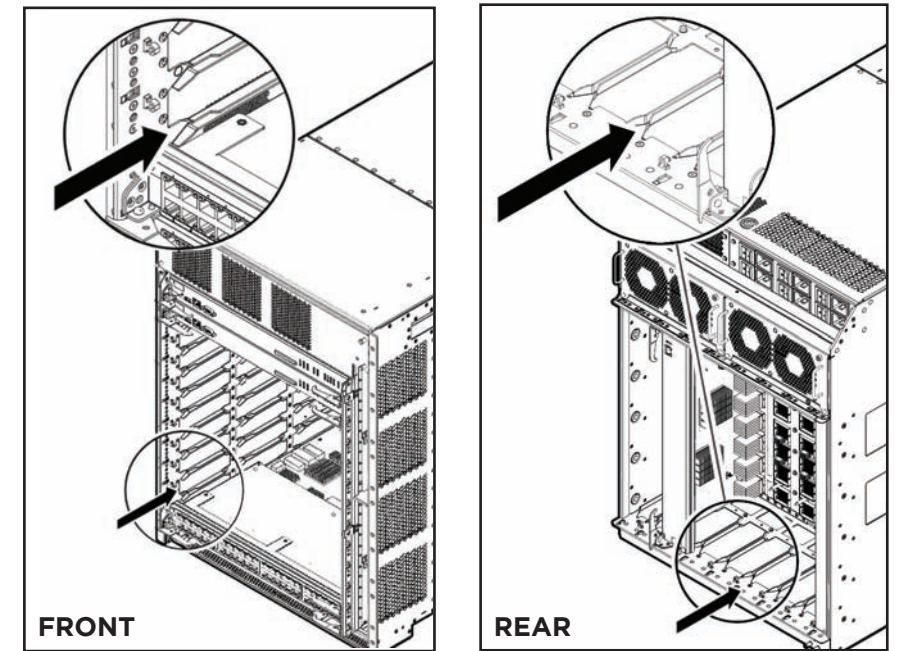

- 5 Apply equal force to each action lever to insert the module into the slot until the module stops moving. Gently seat the module interface connectors by pressing on the outside edges of the module near the action levers.

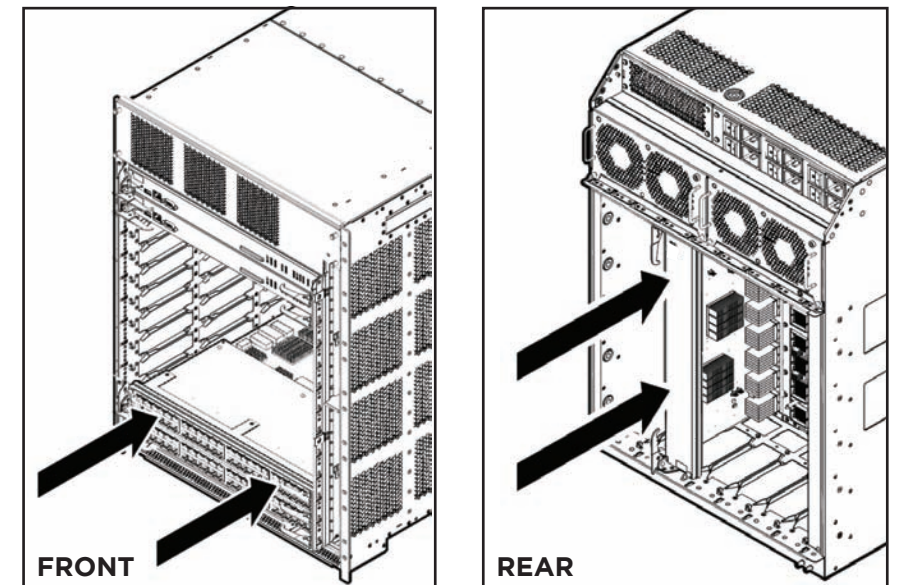

- 7 Turn the screws by hand to catch them. Use a Phillips screwdriver to tighten the screws until snug. Do not overtighten. Do not use a power tool to tighten screws.

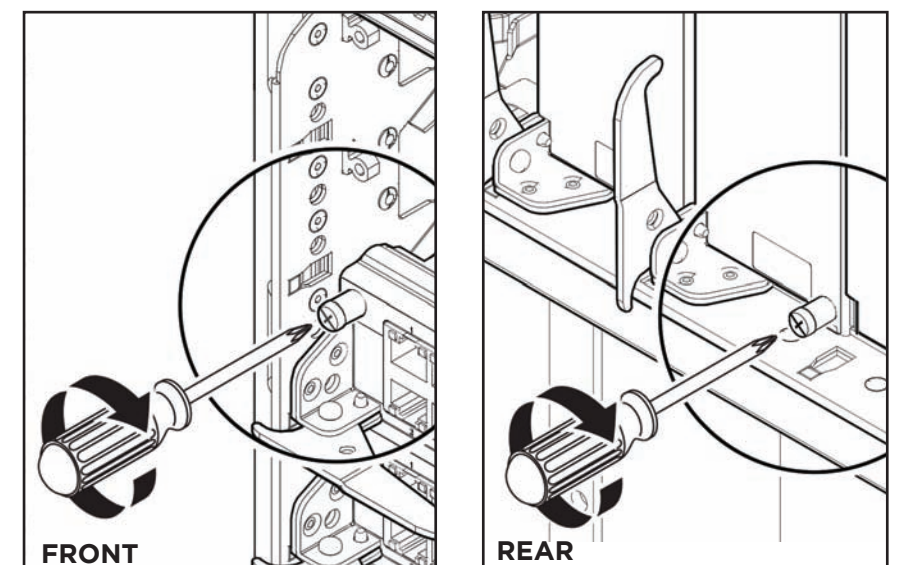



Virtual Services Platform 9010 Module Installation

Start Here

Use this information to install Control Processor (CP), Switch Fabric (SF), and I/O modules in the chassis. The process to install the three types of modules is the same but the location is different. Install the CP and I/O modules vertically in the front of the chassis; install the SF modules horizontally in the back of the chassis. For the latest information about a specific release, see Avaya Virtual Services Platform 9000 Release Notes, NN46250-401.

Note: The CP modules in the VSP 9010 chassis must use a minimum software version of Release 3.4.

Prerequisites

Gather the following tools:

- Phillips # 2 screwdriver
- Antistatic wrist strap

Protecting modules

CAUTION: Risk of equipment damage
Do not touch components or connector pins with your hand, or damage can result.

Note: If you have the external Flash card media for your CP module, you must install it prior to power on of the chassis and CP modules.

You must have a minimum of 3 SF modules installed for proper operation of the VSP 9000.

Modules are heavy. Damage to a module can occur if it bumps into another object, including other modules installed in a chassis. Use both hands to support modules.

Always place the modules on appropriate antistatic material.

Support the module from underneath with two hands. Do not touch the top of the module. Do not touch the pins or electrical connections.

Do not leave slots open. Fill all slots with modules or filler modules to maintain safety compliance, proper cooling, and EMI containment.

Do not over tighten screws. Tighten until snug. Do not use a power tool to tighten screws.

Be careful not to bump module connectors against the ejector levers of an adjacent module. Damage to connectors can result.

1 Unpacking a module

1. Remove the module from the box.
2. Slide your hand in to the anti-static bag and under the tray to support the whole module with one hand while you remove the bag with the other hand.
3. Hold the module from the underside of the tray with both hands. Do not hold the module by the faceplate. Avoid touching or grasping the top of the module. Component damage can result.

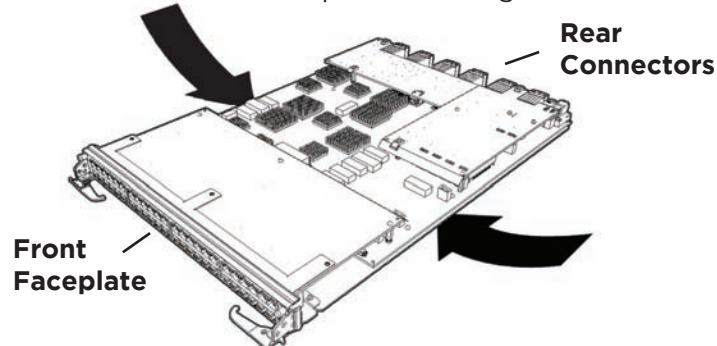

2 Installing a module

Locate the slot where you want to install the module. When installing the SF modules, for proper operation, you must populate slots **SF1** and **SF4**.

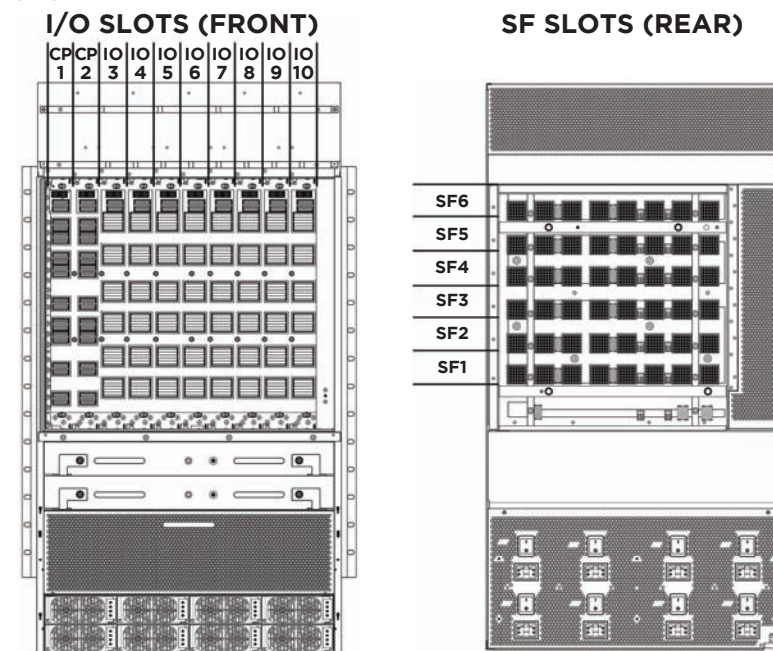

- 4 Before you fully insert the module into the slot, rotate the action levers away from the module until they form a 90° angle with the front of the module. Carefully slide the module partway into the slot.

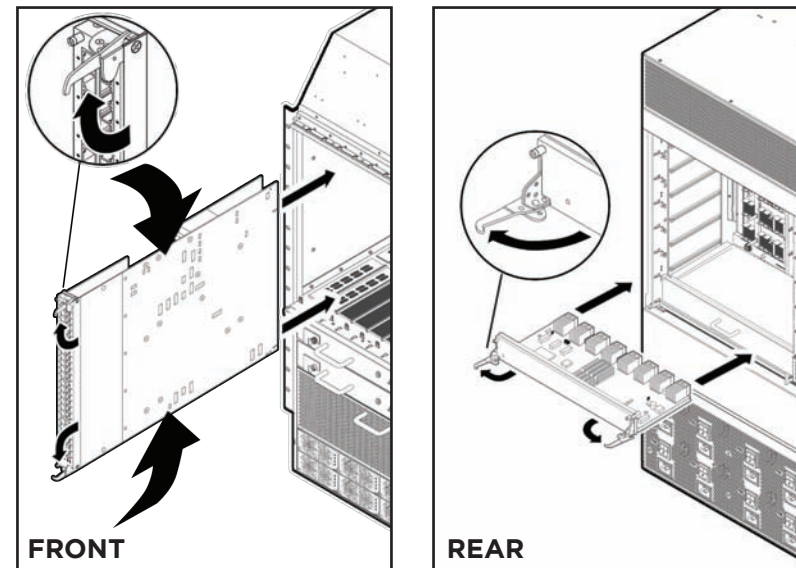

- 6 Continue seating the module by rotating the action levers until the levers are parallel with the front face panel and the module is fully seated.

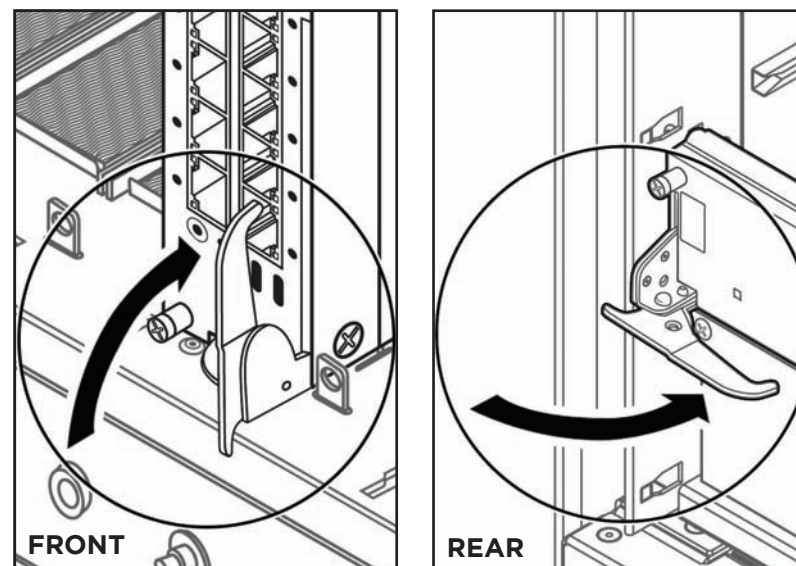

- 3 Align the module base-plate with the guide rails on either side of the opening for horizontal modules, or the guide rails at the top and bottom of the opening for vertical modules.

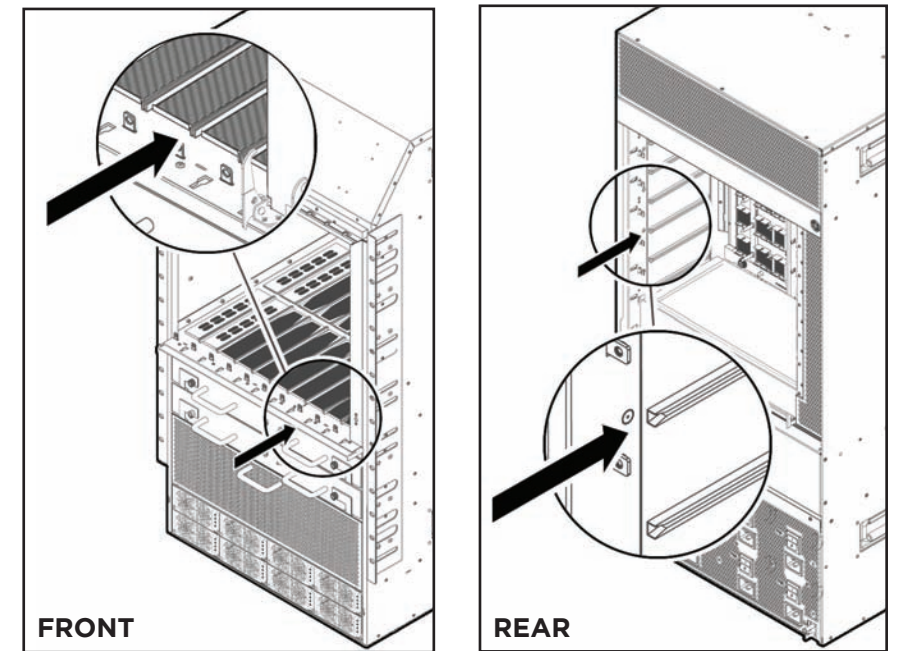

- 5 Apply equal force to each action lever to insert the module into the slot until the module stops moving. Gently seat the module interface connectors by pressing on the outside edges of the module near the action levers.

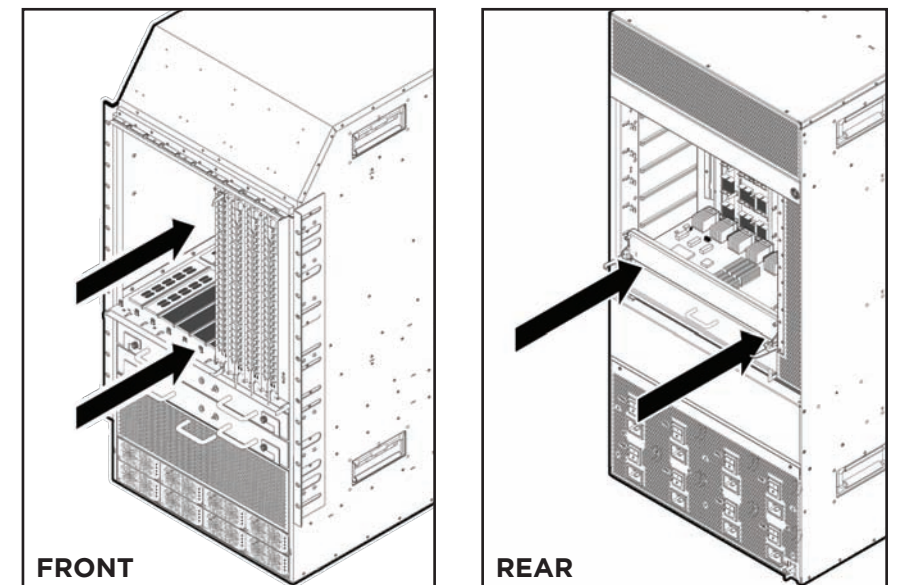

- 7 Turn the screws by hand to catch them. Use a Phillips screwdriver to tighten the screws until snug. Do not overtighten. Do not use a power tool to tighten screws.

