

# 5120 Series Quick Reference

## Follow these steps to get the switch ready for use.

For complete installation instructions see the *Extreme 5120 Hardware Installation Guide* at [www.extremenetworks.com/documentation/](http://www.extremenetworks.com/documentation/)

### Necessary Tools

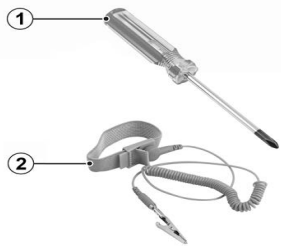

- #2 Phillips screwdriver (magnetic screwdriver recommended)
- ESD-protective wrist strap

## 1 Prepare the Site

The installation site must meet the following requirements:

- Appropriately grounded power receptacles located within 1.8 m (6 ft.)
- A readily accessible device for disconnecting power, such as a breaker or master switch
- Network cabling within reach
- Ensure that the vent openings on the front panel and the rear fan modules are not blocked for proper ventilation
- Temperature between 0°C (32°F) and 50°C (122°F) -- or as noted in “[Operating Conditions](#)” -- with fluctuations of less than 10°C (18°F) per hour.

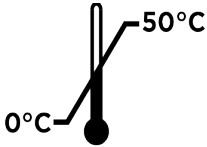

## 2 Unpack the Box

Remove the packing material, and then verify that all of the following components are included:

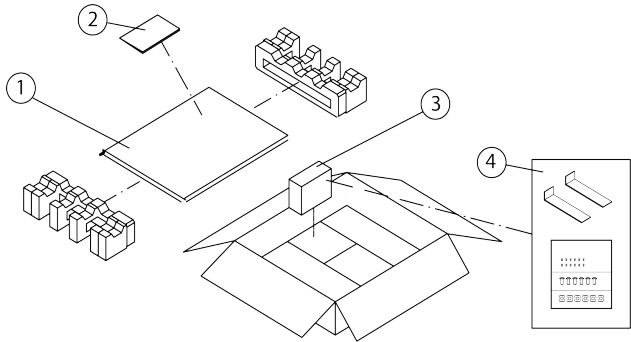

- Switch
- Quick reference guide
- Accessory box
- Rack mount ears (2), accessory bag; Rail screws (12), rack screws (6), rack nuts (6)

Console cables can be ordered separately. See the 5120 Series data sheet for available options. If the switch appears to be damaged, contact Extreme Networks. See “[Getting Help](#)” for more information.

## 3 Install the Switch

You can install any 5120 Series switch in a standard 19-inch equipment rack.

The 5120 Series switch can be installed in a two-post rack. The switch can also be installed in a four-post rack, using just the two front posts for forward mounting or two back posts for rear mounting. The rack mount kit supports flush-mounting and mid-mounting.

### Two-Post Mount

**Note:** This procedure uses a two-post mounting kit, which accommodates rack posts 3 inches or 6 inches wide. Rack ears can support both flush- and mid-mounting.

- Attach a mounting bracket to each side of the switch. You can attach the brackets at the front of the switch or at the middle of the switch, as shown.

- Attach a mounting bracket to each side of the switch. You can attach the brackets at the front of the switch or at the middle of the switch, as shown.

Figure 1: Front Flush-Mount

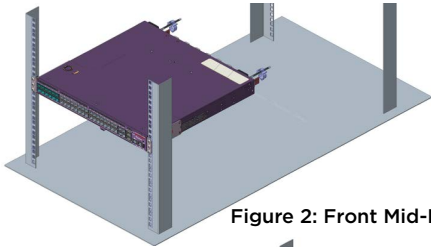

Figure 2: Front Mid-Mount

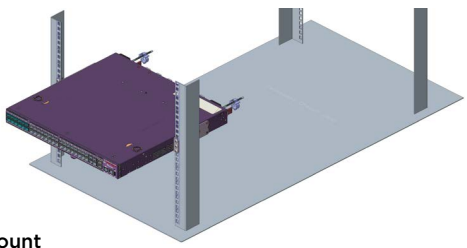

Figure 3: Rear Flush-Mount

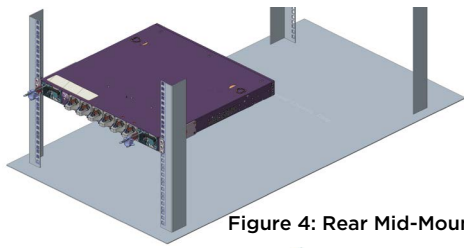
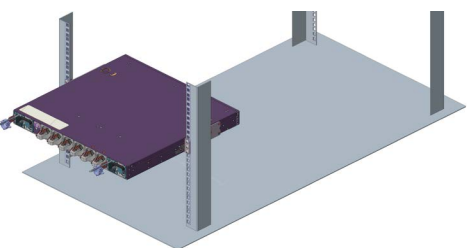

Figure 4: Rear Mid-Mount



- Secure the brackets to the rack posts using rack-mounting screws and nuts that are appropriate for the rack (provided). The switch can be mounted to the two front posts or the two rear posts as shown.

## 4 Connect Power

5120 Series switches run on AC power. Connect the switch to a primary power source.



**Note:** Installing the system as described in this guide meets the protective earth grounding requirements of the National Electrical Code (NEC) UL 62368-1 and IEC 62368-1 standards. However, in some cases, it may be necessary to use an alternative grounding method. In these cases, a 14 AWG wire can be connected between the grounding lug on the chassis and a nearby building ground point.

### Connecting to the Primary Power Source

To attach the 5120 Series switch to a power source, do the following:

- Connect the AC power cord to the AC power input socket on the power supply and an AC power outlet.
- When power is connected, verify that the switch's PWR LED turns green. If the PWR LED does not turn green, refer to the *Extreme 5120 Hardware Installation Guide* for troubleshooting information.

## 5 Update and Configure the Switch

Upgrade to a generally available (GA) version of the software before you use this unit. Switch Engine is the default operating system (OS) for the 5120 Series. To connect the switch to the network, upgrade it, and configure it for use, follow the steps in the *Extreme 5120 Hardware Installation Guide*.

### Safety Notices



**Caution! Shock hazard!**  
**Disconnect all power inputs before servicing.**



**Electrical Hazard:** Only qualified instructed or skilled personnel should perform installation, repair, or disassembly procedures.  
**Risques d'électrocution:** Seul un personnel qualifié ou expérimenté peut effectuer les procédures d'installation, de réparation ou de démontage.  
**Warning:** Extreme Networks power supplies do not have switches for turning the unit on and off. Before servicing, disconnect all power cords to remove power from the device. Make sure that these connections are easily accessible.  
**Avvertimento:** Les alimentations d'Extreme Networks n'ont pas d'interrupteurs pour allumer ou éteindre l'appareil. Avant l'entretien, débranchez tous les cordons d'alimentation pour couper l'alimentation de l'appareil. Assurez-vous que ces connexions sont facilement accessibles.  
**Warning:** This equipment is designed for installation in restricted access locations and suitable for installation in Information Technology Rooms in accordance with Article 645 of the National Electrical Code and NFPA 75, not suitable for use in locations where children are likely to be present.  
**Avvertimento:** Cet équipement est conçu pour être installé dans des endroits à accès restreint et peut être installé dans des salles informatiques conformément à l'article 645 du Code national de l'électricité et à la norme NFPA 75, et ne peut être installé dans des endroits où des enfants sont susceptibles d'être présents.  
**Warning:** A dedicated Listed circuit breaker rated at 15A is to be used for each power supply connection.  
**Avvertimento:** Un disjoncteur certifié 15A et dédié à l'installation doit être utilisé pour chaque connexion d'alimentation.  
**Caution:** Before mounting the device, ensure that the rack can support it without compromising stability. Otherwise, personal injury or equipment damage may result.  
**Caution:** Follow appropriate ESD procedures when unpacking and handling the switch. These include unpacking the switch in an ESD-safe environment and wearing appropriate ESD protective gear, such as ESD-safe footwear and ESD wrist straps where appropriate.  
**Warning:** This unit must be installed indoors. The unit, AC power adapter, and its cables are not designed for outdoor use.  
**Caution:** Use of controls or adjustments or performance of procedures other than those specified herein may result in hazardous radiation exposure.  
**Warning:** Do not use optical instruments to view the laser output. The use of optical instruments to view laser output increases eye hazard. Use only UL/CSA, IEC/EN60825-1/-2 recognized pluggable modules.  
**Avvertimento:** Ne pas utiliser d'instruments optiques pour mesurer la puissance laser. L'utilisation d'instruments optiques pour mesurer la puissance laser peut augmenter les risques de dommages oculaires. Utilisez uniquement des modules certifiés UL/CSA, IEC/EN60825-1 /-2.

## Hardware Components

5120-44X-4Y-2C Front Panel

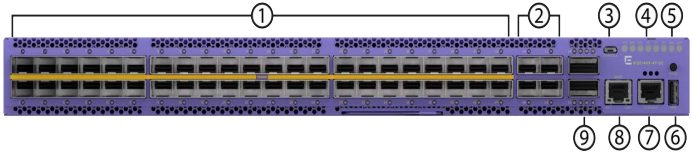

5120-24X-4Y Front Panel

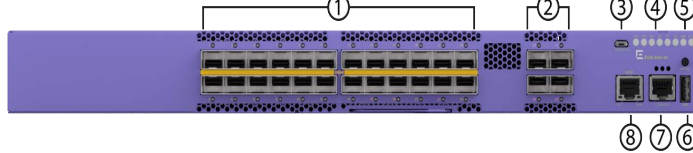

5120-24XT-4Y Front Panel

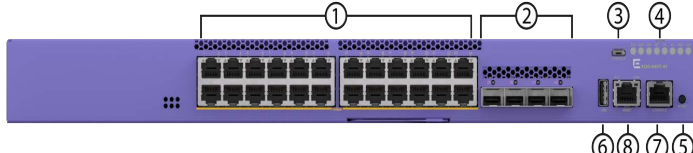

- 1Gb/10Gb SFP+ ports (1Gb/10GBase-T non-PoE ports for 5120-24XT-4Y)
- 10Gb/25Gb SFP28 ports
- Micro-B USB serial console port
- System LEDs
- Mode button
- USB Type A port
- RJ-45 serial console port
- 100/1000BASE-T out-of-band management port
- 100Gb QSFP28 uplink ports

5120-44X-4Y-2C Rear Panel



5120-24X-4Y and 5120-24XT-4Y Rear Panel



For component details, see the *Extreme 5120 Hardware Installation Guide*.

- Modular AC power supplies
- Grounding lug
- Fan modules
- Filler panels

## Operating Conditions

### Operating Temperature:

0°C (32°F) to 50°C (122°F) up to 3000 m (10,000 ft), front-to-back and back-to-front airflow

### One fan failure:

5120-44X-4Y-2C  
0°C (32°F) to 50°C (122°F) at sea level and 45°C (113°F) at 3000 m (10,000 ft), front-to-back airflow  
0°C (32°F) to 45°C (113°F) at sea level and 40°C (104°F) at 3000 m (10,000 ft), back-to-front airflow

5120-24X-4Y  
0°C (32°F) to 50°C (122°F) at sea level and at 3000 m (10,000 ft), front-to-back airflow  
50°C (32°F) to 0°C (122°F) at sea level and 45°C (113°F) at 3000 m (10,000 ft), back-to-front airflow

5120-24XT-4Y  
0°C (32°F) to 50°C (122°F) up to 3000 m (10,000 ft), front-to-back and back-to-front airflow

### Storage Temperature:

-40°C to 70°C (-40°F to 158°F)

### Operating Relative Humidity:

5% to 95% (non-condensing)

## Interfaces

Each Extreme 5120 Series switch includes a Micro-B USB serial console port, an RJ-45 serial console port, a 100/1000BASE-T out-of-band management port, and a USB Type A storage port. 5120 Series switches are pre-loaded with the Switch Engine OS.

The following table lists the specific interfaces for each switch.

5120-44X-4Y-2C (base)	Stackable switch with 44 1Gb/10Gb SFP+ ports, 4 10Gb/25Gb SFP28 ports, 2 100Gb QSFP28 Universal/stack/uplink ports, 6 empty fan slots, and 2 empty modular power supply unit slots.
5120-44X-4Y-2C-AC-F	Stackable switch with 44 1Gb/10Gb SFP+ ports, 4 10Gb/25Gb SFP28 ports, 2 100Gb QSFP28 Universal/stack/uplink ports, 6 fans, 1 modular AC power supply unit, and 1 empty modular power supply unit slot. Front-to-back airflow.
5120-44X-4Y-2C-AC-R	Stackable switch with 44 1Gb/10Gb SFP+ ports, 4 10Gb/25Gb SFP28 ports, 2 100Gb QSFP28 Universal/stack/uplink ports, 6 fans, 1 modular AC power supply unit, and 1 empty modular power supply unit slot. Back-to-front airflow.
5120-44X-4Y-2C-TAA (base)	Stackable switch with 44 1Gb/10Gb SFP+ ports, 4 10Gb/25Gb SFP28 ports, 2 100Gb QSFP28 Universal/stack/uplink ports, 6 empty fan slots, and 2 empty modular power supply unit slots. TAA compliant.
5120-44X-4Y-2C-AC-F-TAA	Stackable switch with 44 1Gb/10Gb SFP+ ports, 4 10Gb/25Gb SFP28 ports, 2 100Gb QSFP28 Universal/stack/uplink ports, 6 fans, 1 modular AC power supply unit, and 1 empty modular power supply unit slot. Front-to-back airflow. TAA compliant.
5120-24X-4Y (base)	Stackable switch with 24 1Gb/10Gb SFP+ ports, 4 10Gb/25Gb SFP28 ports, 4 empty fan slots, and 2 empty modular power supply unit slots.
5120-24X-4Y-AC-F	Stackable switch with 24 1Gb/10Gb SFP+ ports, 4 10Gb/25Gb SFP28 ports, 4 fans, 1 modular AC power supply unit, and 1 empty modular power supply unit slot. Front-to-back airflow.
5120-24X-4Y-AC-R	Stackable switch with 24 1Gb/10Gb SFP+ ports, 4 10Gb/25Gb SFP28 ports, 4 fans, 1 modular AC power supply unit, and 1 empty modular power supply unit slot. Back-to-front airflow.
5120-24X-4Y-TAA (base)	Stackable switch with 24 1Gb/10Gb SFP+ ports, 4 10Gb/25Gb SFP28 ports, 4 empty fan slots, and 2 empty modular power supply unit slots. TAA compliant.
5120-24X-4Y-AC-F-TAA	Stackable switch with 24 1Gb/10Gb SFP+ ports, 4 10Gb/25Gb SFP28 ports, 4 fans, 1 modular AC power supply unit, and 1 empty modular power supply unit slot. Front-to-back airflow. TAA compliant.
5120-24XT-4Y (base)	Stackable switch with 24 1Gb/10GBase-T non-PoE ports, 4 10Gb/25Gb SFP28 ports, 4 empty fan slots, and 2 empty modular power supply unit slots.
5120-24XT-4Y-AC-F	Stackable switch with 24 1Gb/10GBase-T non-PoE ports, 4 10Gb/25Gb SFP28 ports, 4 fans, 1 modular AC power supply unit, and 1 empty modular power supply unit slot. Front-to-back airflow.
5120-24XT-4Y-AC-R	Stackable switch with 24 1Gb/10GBase-T non-PoE ports, 4 10Gb/25Gb SFP28 ports, 4 fans, 1 modular AC power supply unit, and 1 empty modular power supply unit slot. Back-to-front airflow.
5120-24XT-4Y-TAA (base)	Stackable switch with 24 1Gb/10GBase-T non-PoE ports, 4 10Gb/25Gb SFP28 ports, 4 empty fan slots, and 2 empty modular power supply unit slots. TAA compliant.
5120-24XT-4Y-AC-F-TAA	Stackable switch with 24 1Gb/10GBase-T non-PoE ports, 4 10Gb/25Gb SFP28 ports, 4 fans, 1 modular AC power supply unit, and 1 empty modular power supply unit slot. Front-to-back airflow. TAA compliant.

### Power Supply and Fan Options

XN-ACPWR-550W-FB-A	550W AC power supply with front-to-back airflow for 5120 Series switches.
XN-ACPWR-550W-BF-A	550W AC power supply with back-to-front airflow for 5120 Series switches.
XN-FAN-005-F	Fan module with front-to-back airflow for 5120 Series switches.
XN-FAN-005-R	Fan module with back-to-front airflow for 5120 Series switches.



Available Rack-Mount Kits	
XN-2P-RMKIT-014	Two-post rack mount kit for 5120 Series switches for use with two- or four-post racks.
Power Specifications	
All models	AC Input: 100-120/200-240 VAC, 50-60 Hz, 2.5/1.2 A Max. for each PSU

## Getting Help

For additional support related to 5120 Series switches or this document, contact Extreme Networks using one of the following methods:

Product Documentation	<a href="https://www.extremenetworks.com/documentation/">https://www.extremenetworks.com/documentation/</a>
Global Technical Assistance Center (GTAC)	Phone: 1-800-998-2408 (toll-free in U.S. and Canada) or +1-408-579-2826. For the support phone number in your country, visit: <a href="https://www.extremenetworks.com/support/contact/">https://www.extremenetworks.com/support/contact/</a>
GTAC Knowledge	Get on-demand and tested resolutions from the GTAC Knowledgebase, or create a help case if you need more guidance. Visit: <a href="https://gtacknowledge.extremenetworks.com/">https://gtacknowledge.extremenetworks.com/</a>
The Hub	A forum for Extreme customers to connect with one another, get questions answered, share ideas and feedback, and get problems solved. The community is monitored by Extreme Networks employees, but is not intended to replace specific guidance from GTAC. Visit: <a href="https://community.extremenetworks.com">https://community.extremenetworks.com</a>
Support Portal	Manage cases, downloads, service contracts, product licensing, and training and certifications. Visit: <a href="https://support.extremenetworks.com/">https://support.extremenetworks.com/</a>

## Notice

Copyright © 2024 Extreme Networks, Inc. All Rights Reserved.

### Legal Notices

Extreme Networks, Inc. reserves the right to make changes in specifications and other information contained in this document and its website without prior notice. The reader should in all cases consult representatives of Extreme Networks to determine whether any such changes have been made. The hardware, firmware, software or any specifications described or referred to in this document are subject to change without notice.

### Trademarks

Extreme Networks and the Extreme Networks logo are trademarks or registered trademarks of Extreme Networks, Inc. in the United States and/or other countries. All other names (including any product names) mentioned in this document are the property of their respective owners and may be trademarks or registered trademarks of their respective companies/owners. For additional information on Extreme Networks trademarks, please see: [www.extremenetworks.com/company/legal/trademarks/](http://www.extremenetworks.com/company/legal/trademarks/)

## Warranty

Warranty information for 5120 switches is located online at: [www.extremenetworks.com/support/policies/](http://www.extremenetworks.com/support/policies/)

## Regulatory and Compliance Information

### Federal Communications Commission (FCC) Notice

This device complies with Part 15 of the FCC rules. Operation is subject to the following two conditions: (1) this device may not cause harmful interference, and (2) this device must accept any interference received, including interference that may cause undesired operation.

**NOTE:** This equipment has been tested and found to comply with the limits for a class A digital device, pursuant to Part 15 of the FCC rules. These limits are designed to provide reasonable protection against harmful interference when the equipment is operated in a commercial environment. This equipment uses, generates, and can radiate radio frequency energy and if not installed in accordance with the operator’s manual, may cause harmful interference to radio communications. Operation of this equipment in a residential area is likely to cause interference in which case the user will be required to correct the interference at his own expense.

**WARNING:** Changes or modifications made to this device which are not expressly approved by the party responsible for compliance could void the user’s authority to operate the equipment.

### Industry Canada Notice CAN ICES-3 (A)/NMB-3(A)

This digital apparatus does not exceed the class A limits for radio noise emissions from digital apparatus set out in the Radio Interference Regulations of the Canadian Department of Communications. Le présent appareil numérique n’émet pas de bruits radioélectriques dépassant les limites applicables aux appareils numériques de la class A prescrites dans le Règlement sur le brouillage radioélectrique édicté par le ministère des Communications du Canada.

### Class A ITE Notice

**WARNING:** This equipment is compliant with Class A of CISPR 32. In a residential environment this equipment may cause radio interference.

### Product Safety

This product complies with the following international safety standards:

- UL 62368-1
- UL 60950-1
- CAN/CSA C22.2 No. 62368-1-19
- CAN/CSA C22.2 No. 60950-1-07
- IEC 62368-1
- EN 62368-1
- 2014/35/EU
- CNS 15598-1
- GB 4943.1

### Optical Module Compliance

Extreme Networks pluggable optical modules and direct-attach cables meet the following regulatory requirements:

- UL and/or CSA registered component for North America
- Class 1 or Class 1M Laser Product
- FCC 21 CFR Chapter 1, Sub-chapter J in accordance with FDA & CDRH requirements
- IEC/EN 60825-1, IEC/EN 60825-2 or later, European Standard

### Korea EMC Statement

이 기기는 업무용 환경에서 사용할 목적으로 적  
합성평가를 받은 기기로서 가정용 환경에서 사  
용하는 경우 전파간섭의 우려가 있습니다.

### Australia (RCM)

**WARNING:** This equipment is compliant with Class A of CISPR 32. In a residential environment this equipment may cause radio interference.

### Electromagnetic Compatibility (EMC)

This product complies with the following: FCC 47 CFR Part 15 Subpart B Class A (US), ICES-003 (Canada), EN 55032 (ITE Emissions), EN 55035 (ITE Immunity), EN 61000-3-2 (Harmonics), EN 61000-3-3 (Flicker), 2014/30/EU (EMC Directive), EN 300 386 (Telecom), EN 55011 (ISM), EN 61000-6-2 (Ind. Immunity), EN 61000-6-4 (Ind. Emissions), RCM (Australia), VCCI (Japan), MSIP KCC (Korea), BSMI (Taiwan), ANATEL (Brazil), TEC (India), CQC (China).

### VCCI Notice

This is a Class A product based on the standard of the Voluntary Control Council for Interference by Information Technology Equipment (VCCI). If this equipment is used in a domestic environment, radio disturbance may arise. When such trouble occurs, the user may be required to take corrective actions.

この装置は、クラスA機器です。この装置を住宅環境で使用すると  
電波妨害を引き起こすことがあります。この場合には使用者が適切な  
対策を講ずるよう要求されることがあります。 VCCI-A

### BSMI EMC Statement — Taiwan

This is a Class A product. In a domestic environment this product may cause radio interference in which case the user may be required to take adequate measures.

Taiwan BSMI 報關義務人

申請人: 愛爾蘭商極進網絡技術行動有限公司台灣分公司

地址: 臺北市松山區南京東路 4 段 126 號 5 樓

警告：在居住环境中, 运行此设

备可能会造成无线电干扰。

警告:為避免電磁干擾, 本產品

不應安裝或使用於住宅環境。

### Battery Warning- Taiwan

警告

如果更換不正確之電池型式會有爆炸的風險，

請依製造商說明書處理用過之電池。

### Battery Notice



**Warning:** This product contains a battery used to maintain product information. If the battery should need replacement it must be replaced by Service Personnel. Please contact Technical Support for assistance. Risk of explosion if battery is replaced by an incorrect type. Dispose of expended battery in accordance with local disposal regulations.

**Avertissement:** Ce produit renferme une pile servant à conserver les renseignements sur le produit. Le cas échéant, faites remplacer la pile par le personnel du service de réparation. Veuillez communiquer avec l'assistance technique pour du soutien. Il y a risqué d'explosion si la pile est remplacée par un type de pile incorrect. Éliminez les piles usées en conformité aux règlements locaux d'élimination des piles.

### Hazardous Substances- China and Taiwan BSMI RoHS

Guidance concerning the China and Taiwan BSMI RoHS (Restriction of Hazardous Substances) directive for this Extreme Networks® product can be found on the following web page:

<https://www.extremenetworks.com/support/restriction-hazardous-substances/>

The page contains tables detailing the presence of substances defined by the RoHS directive.

### Hazardous Substances - EU

This product complies with the requirements of Directive 2011/65/EU of the European Parliament and of the Council of 8 June 2011 and its amendments (EU) 2015/863 on the restriction of the use of certain hazardous substances in electrical and electronic equipment.

### European Waste Electrical and Electronic Equipment (WEEE) Notice



In accordance with Directive 2012/19/EU of the European Parliament on waste electrical and electronic equipment (WEEE):

- 1** The symbol above indicates that separate collection of electrical and electronic equipment is required.
- 2** When this product has reached the end of its serviceable life, it cannot be disposed of as unsorted municipal waste. It must be collected and treated separately.
- 3** It has been determined by the European Parliament that there are potential negative effects on the environment and human health as a result of the presence of hazardous substances in electrical and electronic equipment.
- 4** It is the users' responsibility to utilize the available collection system to ensure WEEE is properly treated.

For information about the available collection system, please contact Extreme Customer Support at +353 61 705500 (Ireland).

# Extreme Networks

## 5120 Series

### Quick Reference

5120-44X-4Y-2C

5120-44X-4Y-2C-TAA

5120-24X-4Y

5120-24X-4Y-TAA

5120-24XT-4Y

5120-24XT-4Y-TAA

### ExtremeCloud™ IQ

Scan to learn more about **ExtremeCloud IQ** and **ExtremeCloud IQ - Site Engine**.

Your new switch can be managed by ExtremeCloud IQ if cloud management is preferred as well as ExtremeCloud IQ - Site Engine if locally deployed management is preferred.



P/N 9038117-00 Rev. AA

