

XA1400 Series Quick Reference

Follow these steps to get your switch up and running. For complete installation instructions see the *ExtremeAccess Platform XA1400 Series: Hardware Installation Guide* at www.extremenetworks.com/documentation

Tools You'll Need

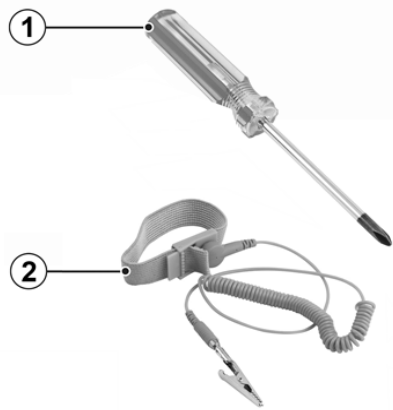

- 1 #2 Phillips screwdriver
(magnetic screwdriver recommended)
- 2 ESD-protective wrist strap

1 Prepare the Site

The installation site must meet the following requirements:

- Appropriate grounded power receptacles located within 1.8 m (6 ft.)
- A readily accessible device for disconnecting power, such as a breaker or master switch
- Network cabling within reach
- At least 7.6 cm (3.0 in.) on all sides, for proper ventilation
- Temperature between 0°C (32°F) and 40°C (104°F) -- or as noted in "Operating Temperature:" -- with fluctuations of less than 10°C (18°F) per hour

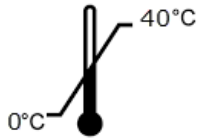

2 Unpack the Box

Remove the packing material. Break the tape seal on the non-conductive bag and remove the switch.

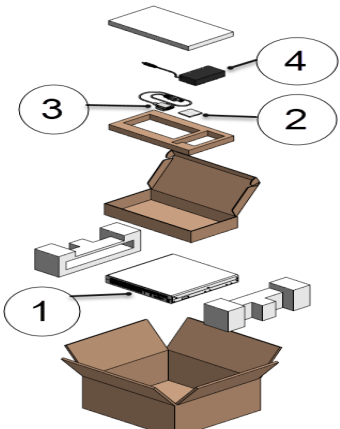

- 1 Switch
- 2 Rubber feet
- 3 Console cable
- 4 Power adapter

If the switch appears to be damaged, contact Extreme Networks. See "Getting Help" for more information.

Extreme Networks does not include power input cords with this product. To purchase the correct power cord for your country, refer to www.extremenetworks.com/product/powercords/. This page lists details for purchasing a power cord from Extreme Networks or from your local supplier.

Mount your XA1400 Series switch in a standard equipment rack, in either of the following ways:

- Four-post mount, using the mounting kit provided.
- Two-post mount, using mounting brackets (not provided) to attach the front or the middle of the switch to the posts.

3 Install the Switch

XA1400 Series switches do not fit in the standard 19 inch rack. You can install an XA1400 Series switch using an optional rack mount kit (see "Available Rack-Mount Kit")

Two-Post Mount

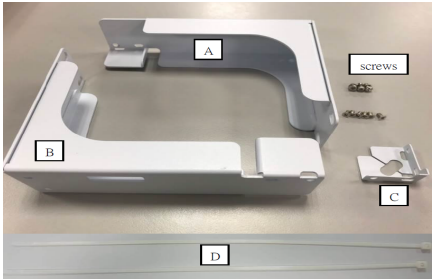

- 1 With the front of the XA1400 Series switch facing you, align the A bracket to the left side of the switch and secure it using 3 (b) screws and one (a) screw.

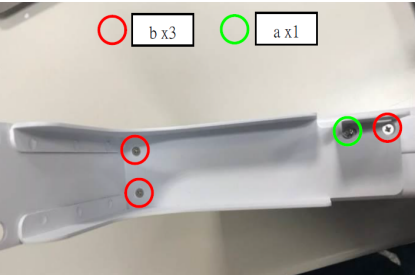
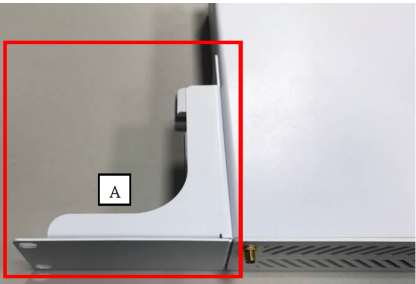

- 2 With the front of the XA1400 Series switch facing you, align the B bracket to the right side of the switch and secure it using 3 (b) screws.

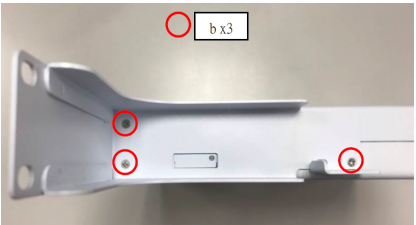

- 3 The C bracket is used to secure the external power supply. With the rear of the XA1400 Series switch facing you, align the C bracket to the left side of the switch and secure it using 2 (a) screws.

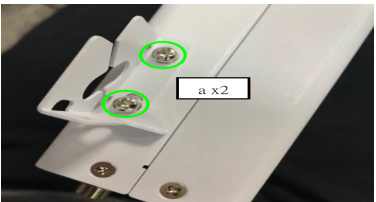
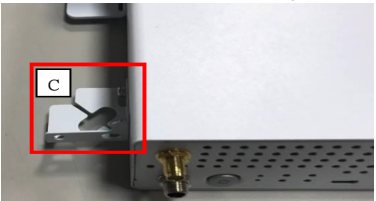

- 4 Insert the zip ties (D) into the slots of the B and C brackets.

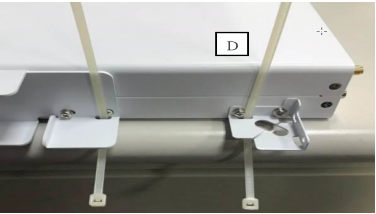

- 5 Secure the external power supply and close the zip appropriately.



- 6 The switch is ready to be mounted to rack post.

4 Install Transceivers

(Optional) Transceivers can send and receive data over optical fiber rather than through electrical wires. This installation procedure applies to all transceivers.



Note: Transceivers are Class 1 laser devices.

- Attach the ESD wrist strap to your wrist and connect the metal end to an appropriate ground point on the rack.
- Remove the transceiver from its packaging.
- If applicable, remove the protective dust cover from the connector.
- Hold the transceiver so that the connector will seat properly.
- Carefully align the transceiver with the port slot.
- Push the transceiver into the port slot until it clicks into place.

5 Connect Power

XA1400 Series switches can run on the following power source:

Table 1 XA1400 Series Powering Method

Power Source	Description
External 12V DC power supply	This Series is powered by an external DC power supply plugged into an AC source. Plug the supply's input jack into the DC power adapter input (see Figure 2, item #1)



Note: When power is connected, verify that the switch's PWR LED turns green. If the PWR LED does not turn green, refer to the *Hardware Installation Guide* for troubleshooting information

6 Configure the Switch

To connect the switch to the network and configure it for use, follow the steps in *Quick Start Configuration for VSP Operating System Software*, found under the VOSS heading at www.extremenetworks.com/documentation.

Safety Notices



Caution: Before mounting the device, ensure that the rack can support it without compromising stability. Otherwise, personal injury and/or equipment damage may result.



Caution: Follow appropriate ESD procedures when unpacking and handling the switch. These include unpacking the switch in an ESD-safe environment and wearing appropriate ESD protective gear, such as ESD-safe footwear and ESD wrist straps where appropriate.



Caution: Use of controls or adjustments or performance of procedures other than those specified herein may result in hazardous radiation exposure.



Warning: Do not use optical instruments to view the laser output. The use of optical instruments to view laser output increases eye hazard. Use only UL/CSA, IEC/EN60825-1/-2 recognized pluggable modules.

Avertissement: Ne pas utiliser d'instruments optiques pour voir la sortie du laser. L'utilisation de instruments optiques pour afficher la sortie laser augmente les risques oculaires. Utilisez uniquement UL/CSA, IEC/EN60825-1/-2 reconnu modules enfichables.



Warning: This equipment is not suitable for use in locations where children are likely to be present.



Avertissement: Cet équipement ne convient pas pour une utilisation dans des endroits où des enfants sont susceptibles d'être présents.

Warning: The power plug must be connected to a properly wired earth ground socket outlet. An improperly wired socket outlet could place hazardous voltages on accessible metal part.

Avertissement: La fiche d'alimentation doit être connectée à une terre correctement mise à la terre. Des prises de courant mal connectées peuvent créer des tensions dangereuses sur les pièces métalliques accessibles.

Hardware Components

Figure 1 XA1400 Series Switch: Front Panel



Figure 2 XA1400 Series Switch: Rear Panel

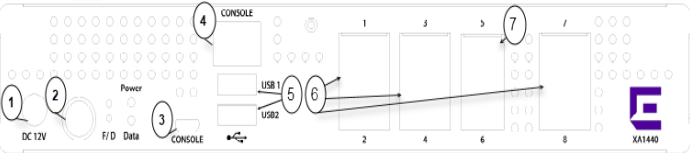

- 1 DC power adapter input
- 2 Power button
- 3 Micro USB console port
- 4 RJ45 Console port
- 5 USB Type A ports
- 6 10/100/1000BASE-T Ethernet ports
- 7 10G SFP+ Ethernet ports

For component details, see the *Hardware Installation Guide*.

Operating Conditions

Operating Temperature: 0°C to 40°C (32°F to 104°F) up to 2000 m (6561 ft)

Storage Temperature: -40°C to 70°C (-40°F to 158°F)

Operating Relative Humidity: 10% to 90% (non-condensing)

Interfaces

Each XA1400 Series switch has an RJ45 console port, one micro USB console, and two USB ports. A two-post mounting kit (part no. XN-2P-RMKIT-XA) is provided with each switch.

The following table lists the additional interfaces for each switch:

XA1440	6 10/100/1000BASE-T ports, 2 10G SFP+ ports, 1 RJ45 Console port, quad core X86 CPU, 8GB RAM, 32GB SSD, one 12V DC power adapter and fan, VOSS base license.
XA1480	6 10/100/1000BASE-T ports, 2 10G SFP+ ports, 1 RJ45 Console port, octal core X86 CPU, 8GB RAM, 64GB SSD, one 12V DC power adapter and fan, VOSS base license.

Power Specifications

All models	DC Input: 12V, 5A
------------	-------------------

Power Supply and Fan Options

XA1400-PWR-ADPT	12V DC power supply, fanless
-----------------	------------------------------

Available Rack-Mount Kit

XN-2P-RMKIT-XA	Two-post rack-mount kit for ExtremeAccess Platform 1400 Series models. Includes brackets for front mount of chassis in a two-post rack.
----------------	---

Getting Help

For additional support related to XA1400 Series or this document, contact Extreme Networks using one of the following methods:

Product Documentation	https://www.extremenetworks.com/documentation/
Global Technical Assistance Center (GTAC)	Phone: 1-800-998-2408 (toll-free in U.S. and Canada) or +1-408-579-2826. For the support phone number in your country, visit: http://www.extremenetworks.com/support/contact/
GTAC Knowledge	Get on-demand and tested resolutions from the GTAC Knowledgebase, or create a help case if you need more guidance. Visit: https://gtacknowledge.extremenetworks.com/
The Hub	A forum for Extreme customers to connect with one another, get questions answered, share ideas and feedback, and get problems solved. The community is monitored by Extreme Networks employees, but is not intended to replace specific guidance from GTAC. Visit: https://community.extremenetworks.com
Support Portal	Manage cases, downloads, service contracts, product licensing, and training and certifications. Visit: http://support.extremenetworks.com/

Notice

Copyright © 2019 Extreme Networks, Inc. All Rights Reserved.

Legal Notices

Extreme Networks, Inc. reserves the right to make changes in specifications and other information contained in this document and its website without prior notice. The reader should in all cases consult representatives of Extreme Networks to determine whether any such changes have been made.

The hardware, firmware, software or any specifications described or referred to in this document are subject to change without notice.

Trademarks

Extreme Networks and the Extreme Networks logo are trademarks or registered trademarks of Extreme Networks, Inc. in the United States and/or other countries.

All other names (including any product names) mentioned in this document are the property of their respective owners and may be trademarks or registered trademarks of their respective companies/owners. For additional information on Extreme Networks trademarks, please see: www.extremenetworks.com/company/legal/trademarks/

Warranty

Warranty information for XA1400 Series series switches is located online at:www.extremenetworks.com/support/policies/

Regulatory and Compliance Information

Federal Communications Commission (FCC) Notice

This device complies with Part 15 of the FCC rules. Operation is subject to the following two conditions: (1) this device may not cause harmful interference, and (2) this device must accept any interference received, including interference that may cause undesired operation.

NOTE: This equipment has been tested and found to comply with the limits for a class A digital device, pursuant to Part 15 of the FCC rules. These limits are designed to provide reasonable protection against harmful interference when the equipment is operated in a commercial environment. This equipment uses, generates, and can radiate radio frequency energy and if not installed in accordance with the operator's manual, may cause harmful interference to radio communications. Operation of this equipment in a residential area is likely to cause interference in which case the user will be required to correct the interference at his own expense.

WARNING: Changes or modifications made to this device which are not expressly approved by the party responsible for compliance could void the user's authority to operate the equipment.

Industry Canada Notice
CAN ICES-3 (A)/NMB-3(A)

This digital apparatus does not exceed the class A limits for radio noise emissions from digital apparatus set out in the Radio Interference Regulations of the Canadian Department of Communications.

Le présent appareil numérique n'émet pas de bruits radioélectriques dépassant les limites applicables aux appareils numériques de la class A prescrites dans le Règlement sur le brouillage radioélectrique édicté par le ministère des Communications du Canada.

Class A ITE Notice

WARNING: This equipment is compliant with Class A of CISPR 32. In a residential environment this equipment may cause radio interference.

Product Safety

This product complies with the following international safety standards:

- UL 62368-1 2nd Edition, 2014-12-01
- UL 60950-1, 2nd Edition, 2014-10-14
- CAN/CSA C22.2 No. 62368-1-14 2nd Edition
- CAN/CSA C22.2 No. 60950-1-07, 2nd Edition, 2014-10
- IEC 62368-1:2014 (Second Edition)
- IEC 60950-1:2005 (Second Edition) + Am 1:2009 + Am 2:2013
- EN 62368-1:2014/A11:2017
- EN 60950-1:2006 + A11:2009 + A1:2010 + A12:2011 + A2:2013
- 2014/35/EU
- CNS 14336-1
- GB 4943.1-2011

Optical Module Compliance

Extreme Networks pluggable optical modules and direct-attach cables meet the following regulatory requirements:

- UL and/or CSA registered component for North America
- Class 1 Laser Product
- FCC 21 CFR Chapter 1, Sub-chapter J in accordance with FDA & CDRH requirements
- IEC/EN 60825-1:2007, IEC/EN 60825-2:2004+A1+A2 or later, European Standard

Korea EMC Statement

이 기기는 업무용 환경에서 사용할 목적으로 적

합성평가를 받은 기기로서 가정용 환경에서 사

용하는 경우 전파간섭의 우려가 있습니다.

Australia (RCM)

WARNING: This equipment is compliant with Class A of CISPR 32. In a residential environment this equipment may cause radio interference.

Electromagnetic Compatibility (EMC)

This product complies with the following: FCC 47 CFR Part 15 Subpart B class A (US), ICES-003 (Canada), EN 55032 (ITE Emissions), EN 55024 (ITE Immunity), EN 61000-3-2 (Harmonics), EN 61000-3-3 (Flicker), 2014/30/EU (EMC Directive), EN 300 386 (Telecom), EN 55011 (ISM), EN 61000-6-2 (Ind. Immunity), EN 61000-6-4 (Ind. Emissions), RCM (Australia), VCCI (Japan), MSIP KCC (Korea), BSMI (Taiwan), ANATEL (Brazil), CCC (China), and SABS (South Africa)

VCCI Notice

This is a Class A product based on the standard of the Voluntary Control Council for Interference by Information Technology Equipment (VCCI). If this equipment is used in a domestic environment, radio disturbance may arise. When such trouble occurs, the user may be required to take corrective actions.

この装置は、クラスA機器です。この装置を住宅環境で使用すると電波妨害を引き起こすことがあります。この場合には使用者が適切な対策を講ずるよう要求されることがあります。

VCCI－A

警告使用者：
此為甲類資訊技術設備・於居住環境中使用時・可能會造成射頻擾動・在此種情況下・使用者會被要求採取某些適當的對策・

此为A级产品，在生活环境中，该产品可能会造成无线电干扰。

在这种情况下，可能需要用户对干扰采取切实可行的措施。

BSMI EMC Statement — Taiwan

This is a Class A product. In a domestic environment this product may cause radio interference in which case the user may be required to take adequate measures.

Taiwan BSMI 報關義務人

申請人: 香港商極進網路有限公司台灣分公司

地址: 臺北市松山區復勢里南京東路 4 段 126 號 5 樓

Battery Warning — Taiwan

警告

如果更換不正確之電池型式會有爆炸的風險，

請依製造商說明書處理用過之電池。



Battery Notice

Warning: This product contains a battery used to maintain product information. If the battery should need replacement it must be replaced by Service Personnel. Please contact Technical Support for assistance.

Risk of explosion if battery is replaced by an incorrect type. Dispose of expended battery in accordance with local disposal regulations.

Avertissement: Ce produit renferme une pile servant à conserver les renseignements sur le produit. Le cas échéant, faites remplacer la pile par le personnel du service de réparation. Veuillez communiquer avec l'assistance technique pour du soutien.

Il y a risque d'explosion si la pile est remplacée par un type de pile incorrect. Éliminez les piles usées en conformité aux règlements locaux d'élimination des piles.

Hazardous Substances- China and Taiwan BSMI RoHS

Guidance concerning the China and Taiwan BSMI RoHS (Restriction of Hazardous Substances) directive for this Extreme Networks® product can be found on the following web page:

www.extremenetworks.com/support/documentation/restriction-hazardous-substances/

The page contains tables detailing the presence of 10 substances defined by the RoHS directive.

Hazardous Substances - EU

This product complies with the requirements of Directive 2011/65/EU of the European Parliament and of the Council of 8 June 2011 on the restriction of the use of certain hazardous substances in electrical and electronic equipment.

European Waste Electrical and Electronic Equipment (WEEE) Notice



In accordance with Directive 2012/19/EU of the European Parliament on waste electrical and electronic equipment (WEEE):

- 1 The symbol above indicates that separate collection of electrical and electronic equipment is required.
- 2 When this product has reached the end of its serviceable life, it cannot be disposed of as unsorted municipal waste. It must be collected and treated separately.
- 3 It has been determined by the European Parliament that there are potential negative effects on the environment and human health as a result of the presence of hazardous substances in electrical and electronic equipment.
- 4 It is the users' responsibility to utilize the available collection system to ensure WEEE is properly treated.

For information about the available collection system, please contact Extreme Customer Support at +353 61 705500 (Ireland).

Extreme Networks

XA1400 Series

Quick Reference

XA1440

XA1480

