

ExtremeMobility 802.11ax/ac/abgn Outdoor AP560m Access Point

Overview of AP560m

The AP560m is a pole-mount bundle that consists of the AP560i access point and the KT-147407-02 bracket kit. The AP560i access point is a cloud-ready, stadium-optimized Wi-Fi 6, and 802.11ax/ac/abgn outdoor access point with internal antenna. The AP560i access point caters to the stadium environment by supporting high density of users and devices. The AP560m access point can be mounted on a wall or on a pole.

 **Note:** The AP560i requires a minimum base firmware of WiNG 7.1.1.

AP560m Ordering Details

The AP560m pole-mount solution can be ordered as a bundle or as separate units.

Part Number	Order Details	Description
AP560m-FCC	Pole-mount access point bundle	802.11ax High-Capacity Indoor/Outdoor access point with IP67 protection from environmental elements.
	<ul style="list-style-type: none">AP560i-FCC access pointKT-147407-02 bracket kit	Targeted for overhead and pole mount deployments.
AP560i-FCC	Standalone access point	Cloud-ready, Dual 5GHz, Dual-band, Sensor radio, Dual Radio 802.11ax/ac/abgn, 4x4:4 MIMO Outdoor 11ax access point. Internal Antenna. Domain: US
KT-147407-02	Outdoor hardware kit for harsh environments	Outdoor mounting hardware kit for outdoor access points, stainless steel for harsh environments.
KT-150173-01	Outdoor access point 12" extension arm mounting kit	Outdoor access point 12" extension arm mounting kit.

 **Note:** The KT-150173-01 is used with the KT-147407-02 mounting kit.

Verifying the AP560m, AP560i, KT-147407-02, and KT-150173-01 Box Contents

Verify the contents of the box and ensure that the following items are available:

Table 1 Contents of the AP560m Box	
Quantity	Item
1	AP560i access point box containing the AP560i access point, Quick Reference, and the Cloud Quick Start Card (see Table 2)
1	KT-147407-02 outdoor hardware kit (see Table 3)

Table 2 Contents of the AP560i Box	
Quantity	Item
1	AP560i Quick Reference
1	Cloud Quick Start Card
1	AP560i access point
1	Ground screw
2	Hex-head M6 screws

 **Note:** The two hex-head M6 screws are not used during the AP560m installation.

Figure 1 AP560i access point

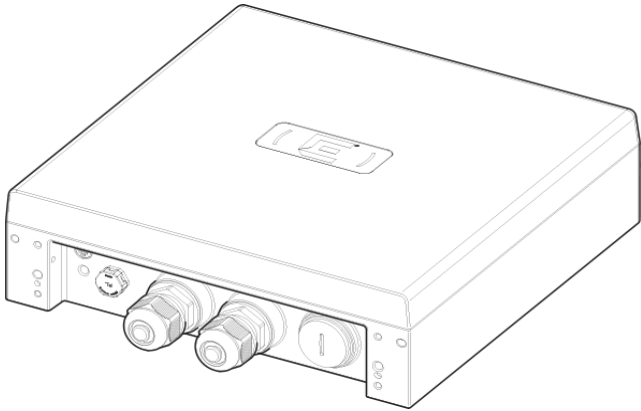



Table 3 Contents of the KT-147407-02 Box	
Quantity	Item
1	KT-147407-02 bracket with three bracket parts: <ul style="list-style-type: none">Flat part with two holes on the metal surface1-axis tilt bracketBoxed pole bracket part with step edges
1	URL Card
6	Hex-head M6 stainless-steel screws
2	Hex-head M12 stainless-steel screws/bolts
2	Hex-head M12 stainless-steel nuts

Table 4 Contents of the KT-150173-01 Box	
Quantity	Item
1	KT-150173-01 12" extension arm
2	Hex-head M12 stainless-steel screws/bolts
2	Hex-head M12 stainless-steel nuts
1	URL Card

 **Note:** The installer must provide required M6 hex-head screws and screw-in anchors to mount the extension arm to a flat surface.

Mounting Options

AP560i can be mounted to a flat surface, like a wall or to a pole using the KT-147407-02 bracket parts, as described in the following table:

Table 5 AP560i mounting brackets usage				
Mounting Bracket and Part Number	Wall Install	Pole Install	Notes	
KT-147407-02 Bracket; comes with three bracket parts	Yes	Yes	For attaching to a wall or a flat surface, use the bracket part that has two holes on the surface of the metal portion. For attaching to a pole, if the 1-axis tilt is not required, attach the pole part of the bracket to the access point. If 1-axis tilt is required, attach the pole part of the KT-147407-02 bracket on top of the second wall part.	
KT-150173-01, 12" extension arm; used with KT-147407-02 bracket parts	Yes; use the flat wall mount part of the KT-147407-02 bracket	Yes; use the pole mount bracket part of the KT-147407-02 bracket	The KT-150173-01 extension arm can also be used by itself without the other KT-147407-02 bracket parts.	

 **Note:** The AP560i access point cannot be installed without the mounting bracket parts or the extension arm.



Warning: When installing the AP560i access point to a wall or to a pole, the cable glands need to face down.

Installing the AP560i access point to a flat surface using the KT-147407-02 bracket

The following hardware is required to install the AP560i access point on a flat surface:

- Flat part of the KT-147407-02 with two holes on the metal surface (see Figure 2)
- 1-axis tilt bracket (see Figure 3)
- Six M6 screws
- Four M6 head-size screws

Figure 2 Flat part of the KT-147407-02 bracket

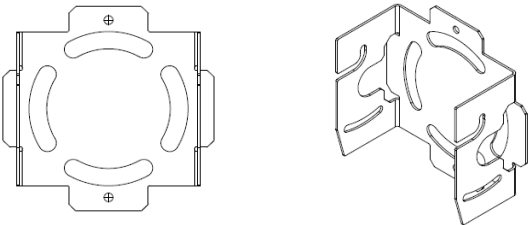
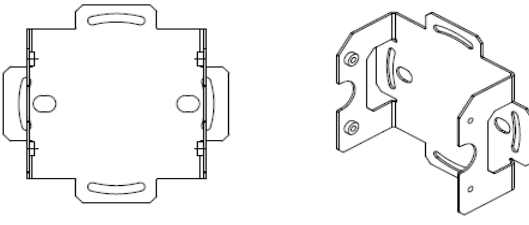

Figure 3 1-axis tilt bracket part



Attaching the AP560i access point to a flat surface using the flat part of the KT-147407-02 bracket and the 1-axis tilt bracket

- Attach the flat part of the KT-147407-02 bracket to the AP560i access point using two M6 screws.
- Using the 1-axis tilt bracket as a template, mark and drill four holes on a wall or on a flat surface.
- Attach the 1-axis tilt bracket to a wall or a flat surface using four M6 head-size screws.
- Align the flat part of the KT-147407-02 bracket inside the 1-axis tilt bracket, and attach the flat bracket to the 1-axis tilt bracket using four M6 screws.
- Tilt the AP560i access point to a desired angle and tighten the four M6 screws to a torque of 45 in-lbs.

The tilt bracket can be adjusted from +15 degrees to -15 degrees of tilt.

Installing the AP560i access point to a pole using the KT-147407-02 bracket

The AP560i can be mounted on a pole with or without tilt. The following hardware is required to install the AP560i access point on a pole without tilt:

- Pole part of the KT-147407-02 bracket (see Figure 4)
- Four M6 screws
- 0.5" wide stainless-steel cable clamps

Figure 4 Pole part of the KT-147407-02 bracket

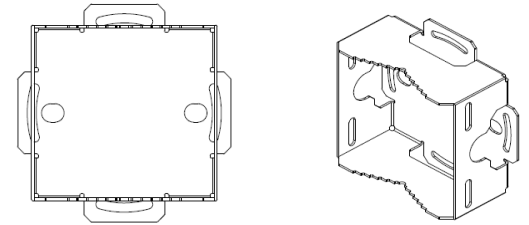

- Attach the pole part of the KT-147407-02 bracket to the AP560i access point using four M6 screws in the circular slots.
- Insert 0.5" wide stainless-steel cable clamps through the long slots on the side of the pole bracket.

- Attach the AP560i access point to a pole by positioning the cable clamps on the pole bracket around a pole.
- Insert the ends of the cable clamp around the pole and tighten it to a torque of 11 in-lbs.

Attaching the AP560i access point to a pole using the flat part of the KT-147407-02 bracket, the 1-axis tilt bracket, and the pole bracket

The following hardware is required to install the AP560i access point on a pole with the tilt part of the KT-147407-02 bracket:

- Flat part of the KT-147407-02 bracket
 - 1-axis tilt part of the KT-147407-02 bracket
 - Two M12 bolts
 - Two M12 hex nuts
 - 0.5" stainless-steel cable clamps
 - Six M6 screws
- Attach the flat part of the KT-147407-02 bracket to the AP560i access point using two M6 screws.
 - Place the flat part of the KT-147407-02 bracket inside the 1-axis tilt bracket, and attach the 1-axis tilt bracket to the flat bracket using four M6 screws.
 - Attach the pole part of the KT-147407-02 bracket on top of the 1-axis tilt part using two M12 bolts through the large bracket holes and fasten it using two M12 hex nuts.

Figure 5 AP560i access point with KT-147407-02 bracket parts

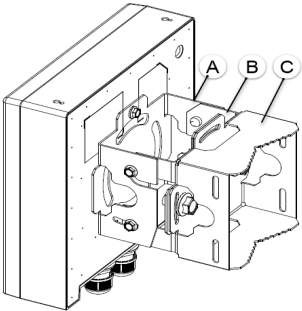

Label	Description
A	Flat part of the KT-147407-02 bracket with two holes on the metal surface
B	1-axis tilt bracket
C	Pole bracket

- Insert 0.5" wide stainless-steel cable clamps through the long slots on the side of the pole bracket.
- Attach the AP560i access point to a pole by positioning the cable clamps on the pole bracket around a pole.
- Insert the ends of the cable clamp around the pole and tighten it to a torque of 11 in-lbs.

Installing the AP560i access point to a wall and to a pole using the KT-150173-01 extension arm

The KT-150173-01 extension arm is used in combination with the wall and pole bracket parts of the KT-147407-02 bracket. The KT-150173-01 extension arm can also be used by itself without using the KT-147407-02 bracket parts.

Figure 6 KT-150173-01 Extension arm

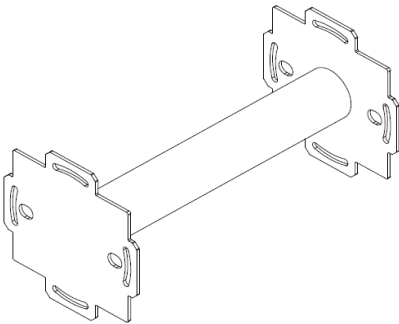

Attaching the AP560i access point to a flat surface using the flat part of the KT-147407-02 bracket, 1-axis tilt-bracket, and the KT-150173-01 extension arm

- Attach the flat part of the KT-147407-02 bracket to the AP560i access point using two M6 screws.
- Place the flat part of the KT-147407-02 bracket inside the 1-axis tilt bracket, and attach the 1-axis tilt bracket to the flat bracket using four M6 screws.

- 3
- Using the KT-150173-01 extension arm as a template, mark four hole centers on a flat surface.The holes must be within the circular cuts in the end of the flange.
- 4
- Attach one end of the KT-150173-01 extension arm to the 1-axis tilt bracket using two hex-head M12 stainless-steel screws and two hex-head M12 stainless-steel nuts through the two large circular holes on the KT-150173-01 extension arm.
- 5
- Attach the KT-150173-01 extension arm, that now has all the access point mounted on the other end to a flat surface using four screws with M6 size hex-heads and screw-in anchors if the bracket is being mounted on a wood surface. If you are mounting the bracket on a concrete surface, use concrete anchors.

The M6 hex-head screws and screw-in anchors must be provided by the installer.

Attaching the AP560i access point to a pole using all three parts of the KT-147407-02 bracket and the KT-150173-01 extension arm

- 1
- Attach the flat part of the KT-147407-02 bracket to the AP560i access point using two M6 screws.
- 2
- Align the flat part of the KT-147407-02 bracket inside the 1-axis tilt bracket, and attach the flat bracket to the 1-axis tilt bracket using four M6 screws.
- 3
- Tilt the AP560i access point to a desired angle and tighten the four M6 screws to a torque of 45 in-lbs.
- 4
- Attach one end of the KT-150173-01 extension arm to the 1-axis tilt bracket using two hex-head M12 stainless-steel screws and two hex-head M12 stainless-steel nuts through the two large circular holes on the KT-150173-01 extension arm.
- 5
- Attach the pole part of the KT-147407-02 bracket on top of the KT-150173-01 extension arm using two M12 screws and two M12 hex nuts.

Figure 7 AP560i with KT-147407-02 bracket parts and KT-150173-01 extension arm

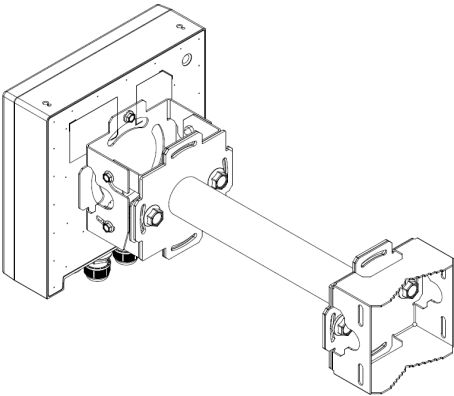

- 6
- Insert 0.5" wide stainless-steel cable clamps through the long slots on the side of the pole bracket.
- 7
- Attach the AP560i access point to a pole by positioning the cable clamps on the pole bracket around a pole.
- 8
- Insert the ends of the cable clamp around the pole and tighten it to a torque of 11 in-lbs.

Professional Installation Instruction

Installation personnel

This product is designed for specific application and needs to be installed by a qualified personnel who has RF and related rule knowledge. The general user shall not attempt to install or change the setting.

Installation location

The product shall be installed at a location where the radiating antenna can be kept 36 cm from nearby person in normal operation condition to meet regulatory RF exposure requirement.

External antenna

Use only the antennas which have been approved by the applicant. The non-approved antenna(s) may produce unwanted spurious or excessive RF transmitting power which may lead to the violation of FCC/IC limit and is prohibited.

Installation procedure

Please refer to user's manual for the detail.

Warning: Please carefully select the installation position and make sure that the final output power does not exceed the limit set force in relevant rules. The violation of the rule could lead to serious federal penalty.

Instructions d'installation professionnelle

Installation

Ce produit est destine a un usage specifique et doit etre installe par un personnel qualifie maitrisant les radiofrequences et les regles s'y rapportant. L'installation et les reglages ne doivent pas etre modifiees par l'utilisateur final.

Emplacement d'installation

En usage normal, afin de respecter les exigences reglementaires concernant l'exposition aux radiofrequences, ce produit doit etre installe de facon a respecter une distance de 36 cm entre l'antenne emettrice et les personnes.

Antenn externe

Utiliser uniquement les antennes approuvees par le fabricant. L'utilisation d'autres antennes peut conduire a un niveau de rayonnement essentiel ou non essentiel depassant les niveaux limites definis par FCC/IC, ce qui est interdit.

ProcEDURE d'installation

Consulter le manuel d'utilisation.
Warning: Avertissement: Choisir avec soin la position d'installation et s'assurer que la puissance de sortie ne depasse pas les limites en vigueur. La violation de cette regle peut conduire a de serieuses penalites federales.

Regulatory and Compliance Information
Safety Guidelines

This section contains notices that are intended to protect your personal safety and prevent damage to the equipment.

Qualified Personnel:

Electrical Hazard: Only qualified personnel should perform installation procedures. Within the context of the safety notes in this documentation, qualified persons are defined as persons who are authorized to commission, ground, and label devices, systems, and circuits in accordance with established safety practices and standards. A qualified person understands the requirements and risks involved with installing electrical equipment in accordance with national codes.

Federal Communications Commission (FCC) Notice

This equipment has been tested and found to comply with the limits for a Class B digital device, pursuant to Part 15 of the FCC Rules. These limits are designed to provide reasonable protection against harmful interference in a residential installation. This equipment generates, uses, and can radiate radio frequency energy and, if not installed and used in accordance with the instructions, may cause harmful interference to radio communications. However, there is no guarantee that interference will not occur in a particular installation. If this equipment does cause harmful interference to radio or television reception, which can be determined by turning the equipment off and on, the user is encouraged to try to correct the interference by one of the following measures:

- Reorient or relocate the receiving antenna.
- Increase the separation between the equipment and receiver.
- Connect the equipment into an outlet on a circuit different from that to which the receiver is connected.
- Consult the dealer or an experienced radio/TV technician for help.

Caution: Any changes or modifications not expressly approved by the party responsible for compliance could void the user's authority to operate this equipment.

This device complies with Part 15 of the FCC Rules. Operation is subject to the following two conditions: (1) This device may not cause harmful interference, and (2) this device must accept any interference received, including interference that may cause undesired operation.

This transmitter must not be co-located or operating in conjunction with any other antenna or transmitter.

This device meets all the other requirements specified in Part 15E, Section 15.407 of the FCC Rules.

Warning: FCC Radiation Exposure Statement: This equipment complies with FCC radiation exposure limits set forth for an uncontrolled environment. This equipment should be installed and operated with minimum distance 20 cm between the radiator and your body.

European Waste Electrical and Electronic Equipment (WEEE) Notice



In accordance with Directive 2012/19/EU of the European Parliament on waste electrical and electronic equipment (WEEE):

- 1
- The symbol above indicates that separate collection of electrical and electronic equipment is required.
- 2
- When this product has reached the end of its serviceable life, it cannot be disposed of as unsorted municipal waste. It must be collected and treated separately.
- 3
- It has been determined by the European Parliament that there are potential negative effects on the environment and human health as a result of the presence of hazardous substances in electrical and electronic equipment.
- 4
- It is the users' responsibility to utilize the available collection system to ensure WEEE is properly treated.

For information about the available collection system, please contact Extreme Environmental Compliance at Green@extremenetworks.com.

ExtremeMobility™
Access Points

Quick Reference

AP560m-FCC

Notice

Copyright © 2019 Extreme Networks, Inc. All Rights Reserved.

Legal Notices

Extreme Networks, Inc. reserves the right to make changes in specifications and other information contained in this document and its website without prior notice. The reader should in all cases consult representatives of Extreme Networks to determine whether any such changes have been made.

The hardware, firmware, software or any specifications described or referred to in this document are subject to change without notice.

Trademarks

Extreme Networks and the Extreme Networks logo are trademarks or registered trademarks of Extreme Networks, Inc. in the United States and/or other countries.

All other names (including any product names) mentioned in this document are the property of their respective owners and may be trademarks or registered trademarks of their respective companies/owners.

For additional information on Extreme Networks trademarks, please see: www.extremenetworks.com/company/legal/trademarks/

Documentation, Installation Videos, & Support
For product support, including Documentation and Installation Videos, visit: www.extremenetworks.com/documentation